

# P-830

Barrier Terminal Blocks &gt; Wire Terminal

Date:2025-12-18Version:1.2

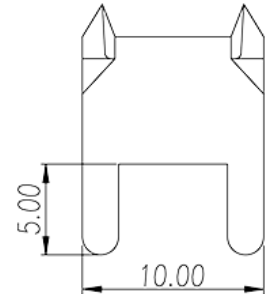
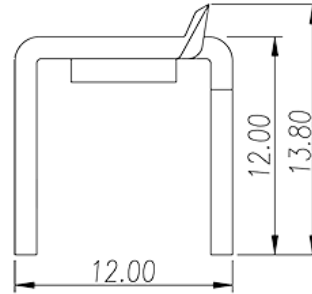

The web catalog is for reference only. Dinkle remains the right of product modification and engineering change of the design.  
The final product is made according to engineering drawing.

## Product Description

Pitch : 8.00 /10.80 mm, 1.2x2.0mm, 85A

## General information

Short description	Barrier terminal blocks, Quick terminal blocks
Category	Quick terminal blocks
Pitch (mm)	8.00 / 10.80
Pin demensions (Thickness x Width)(mm)	1.2x2.0

## Material information

Conductor material	COPPER ALLOY
Plating of conductor surface	Tin PLATED

## Connection data-IEC

Rated current (A)	85
Screw thread	M5

## Drawings

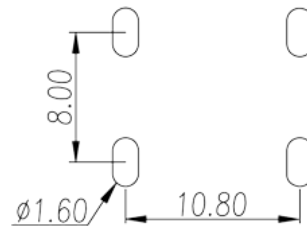
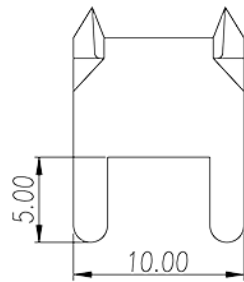
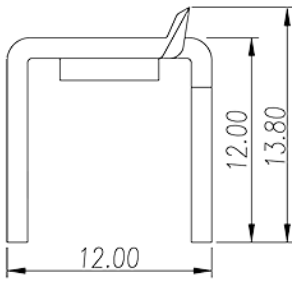

## Approvals

