

# DKM150-C

DIN Rail Terminal Blocks &gt; Stud Connection

Date:2025-08-16

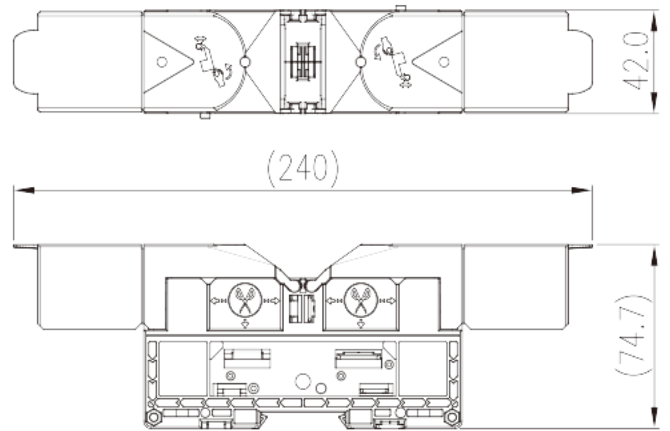

The web catalog is for reference only. Dinkle remains the right of product modification and engineering change of the design.  
The final product is made according to engineering drawing.

## Product Description

M10, 1500V, 350A, Beige (default)

## General information

|                   |  |
|-------------------|--|
| Short description | Panel Mounting DIN Rail terminal blocks, Stud Connection |
| Category          | Feed-through Single Level                                |
| Pitch (mm)        | 42   |
| Color             | Refer to drawing   |
| Connection method | Stud Connection  |
| Type of locking   | Panel Mounting/Rail Mounting                             |
| Length (mm)       | 240  |
| Width (mm)        | 42   |
| Height (mm)       | 74.4   |
| Level             | Single level   |
| Connection points | 2  |

## Material information

|                           |    |
|---------------------------|----|
| Insulation material       | PA |
| Insulation material group | I  |

|  |                   |
|--|-------------------|
| Flame retardant rating , compliant with UL94 | V0                |
| Insulation resistance                        | □500MΩ at DC 500V |

## Connection data-IEC

|  |   |
|--|---|
| Rated voltage (V)  | 1500  |
| Rated current (A)  | 309   |
| Rated voltage (III/3)(V)                                 | 1500  |
| Rated impulse voltage (III/3)(KV)                        | 8   |
| Conductor cross section solid. min (mm <sup>2</sup> )    | 10  |
| Conductor cross section solid.max (mm <sup>2</sup> )     | 150   |
| Conductor cross section stranded. min (mm <sup>2</sup> ) | 10  |
| Conductor cross section stranded. max (mm <sup>2</sup> ) | 150   |
| Screw thread   | M10   |
| Rated torque (N.m)                                       | 10~20   |
| Recommend tightening torque. min (N.m)                   | 10  |
| Recommend tightening torque. max (N.m)                   | 20  |
| Stripping Length (mm)                                    | The stripping length depends on the specification provided by the cablelug manufacturer |
| Mounting rail  | TS-35   |
| End cover plate required                                 | NO  |
| Grounding connections                                    | NO  |

## Connection data-UL

|  |  |
|--|--|
| Rated voltage (UL/CUL Group E)(V)                | 1500                                   |
| Rated current (UL/CUL Group E)(A)                | *Single Cable 285A / Double Cable 350A |
| Min. solid wire connection (AWG) acc. to UL/CUL  | 10                                     |
| Max. solid wire connection AWG acc. to UL/CUL    | 300(kcmil)                             |
| Min. stranded wire connection AWG acc. to UL/CUL | 10                                     |
| Max. stranded wire connection AWG acc. to UL/CUL | 300(kcmil)                             |

## Environment & Safety

|   |     |
|---|-----|
| Back of the hand protection (YES or NO) | NO  |
| Finger protection (YES or NO)           | NO  |
| Operating temperature. max (°C)         | 120 |
| Operating temperature. min (°C)         | -40 |

## UL Recognized

|                            |  |
|----------------------------|--|
| Wire Range (Group E)(AWG)  | 10~300(kcmil)                          |
| Rated voltage (Group E)(V) | 1500                                   |
| Rated current (Group E)(A) | *Single Cable 285A / Double Cable 350A |

## CUL Recognized

|                            |  |
|----------------------------|--|
| Wire Range (Group E)(AWG)  | 10~300(kcmil)                          |
| Rated voltage (Group E)(V) | 1500                                   |
| Rated current (Group E)(A) | *Single Cable 285A / Double Cable 350A |

## Drawings

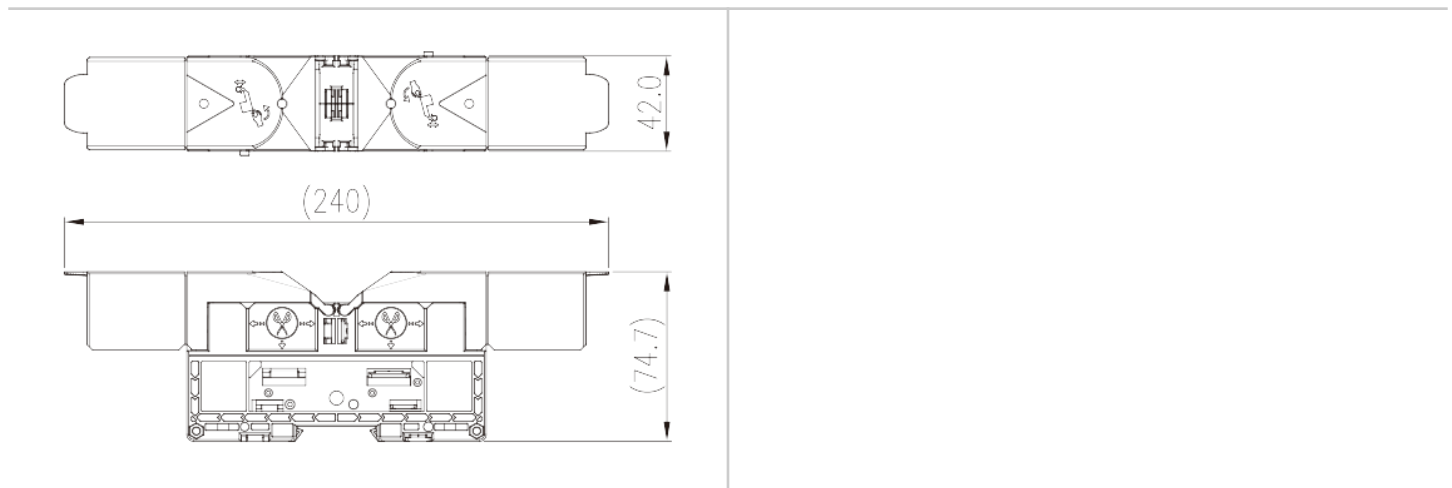

## Approvals

